

the choice of the water gardener  
**Aquagarden**

GUIDE TO

**Aquagarden  
Pond pumps for  
Fountains, Filters  
& Waterfalls  
3750/4750**

Produced exclusively by



Established over 40 years ago, Blagdon are committed to producing a comprehensive range of high quality, easy to use, pond equipment. An ongoing programme of research and development ensures excellent performance and value for all their customers. This product excellence is demonstrated by Blagdon's award winning range of water gardening equipment. As a result Blagdon's reputation for quality is unrivalled amongst experienced pond gardeners and retailers alike.

**Blagdon - The Pond Masters**  
**The name you can rely on**

[www.aquagarden-range.co.uk](http://www.aquagarden-range.co.uk)

Interpet, Vincent Lane,  
Dorking, Surrey, RH4 3YX

Leaflet Code: AG PUMP 3-a



# GUIDE TO Aquagarden pond pumps for Fountains, Filters & Waterfalls 3750/4750

Congratulations on buying an Aquagarden Pump for fountains, filters and waterfalls. Aquagarden pumps are high quality pumps manufactured with advanced technology, to run pond fountains, filters and waterfalls. The powerful motors are easy to maintain fountains having a single moving part impeller system featuring highly wear-resistant ceramic shaft design.

## IMPORTANT

**Please attach proof of purchase to this manual  
and file in a safe place.**

## CONTENTS

<b>Getting to know your Aquagarden pump</b> .....	<b>2</b>
Parts descriptions / spares codes - with exploded diagram .....	3 - 4
Pump performance / flow chart .....	5
Technical specifications .....	5
<b>Installation</b> .....	<b>6</b>
Electrical installation .....	6
Locating your Aquagarden pump .....	7
<b>Maintenance and cleaning</b> .....	<b>9</b>
Routine maintenance .....	9
Monthly maintenance .....	10
Annual maintenance .....	10
Winter storage .....	10
<b>Troubleshooting</b> .....	<b>11</b>
Troubleshooting and maximise performance .....	11
<b>Faults - problem procedure</b> .....	<b>12</b>
Returning faulty pumps .....	12
Consumer advice contact details .....	12
<b>Guarantee</b> .....	<b>13</b>

## GETTING TO KNOW YOUR AQUAGARDEN PUMP

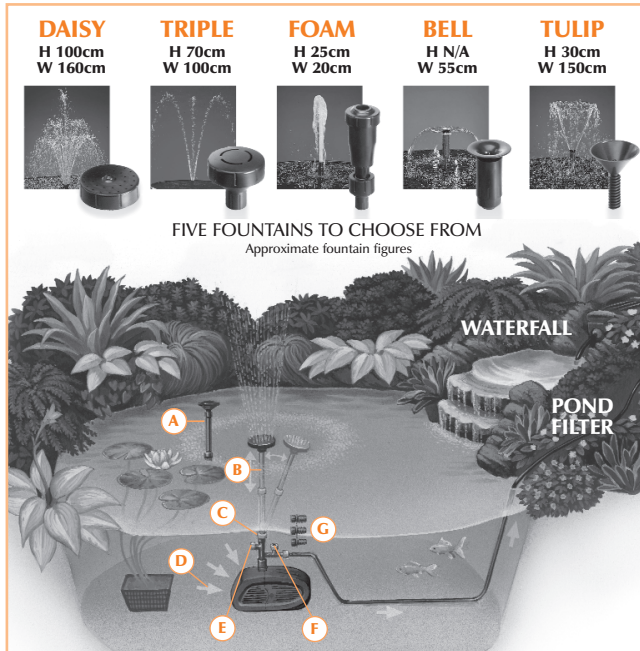

### To run Fountains, Filters, Waterfalls and Features.

- A. 20cm extension pipe.
- B. 30cm adjustable telescopic extension pipe.
- C. 20° +/- ball joint adjustment to compensate for uneven pond floor.
- D. Low maintenance High performance Low velocity intakes prevent the pump from clogging.
- E. Fully adjustable fountain control. Adjusts fountain height and width.
- F. Fully adjustable flow control for filters/waterfalls or features.
- G. Interchangeable 1"/25mm, 3/4"/19mm, 1/2"/12.5mm hose fittings.

## GETTING TO KNOW YOUR AQUAGARDEN PUMP

No.	Part Description
1	Bell Jet
2	Tulip Jet
3	Jet Housing
4	Foam Jet
5	Daisy Jet
6	Triple Jet
7	20cm Extension Pipe
8	30cm Telescopic Extension Pipe
9	Ball Joint
10	T-piece
11	Pump Outlet Flange
12	25mm (1") Hose Fitting
13	18.75mm (3/4") Hose Fitting
14	12.5mm (1/2") Hose Fitting

For spares for your Aquagarden Filter select compatible Blagdon spare part numbers.

**Please note:** Spares/replacements of all of the parts/ fittings listed above are available as part of a 'Complete Fittings Set' - Blagdon Code number: 1014830

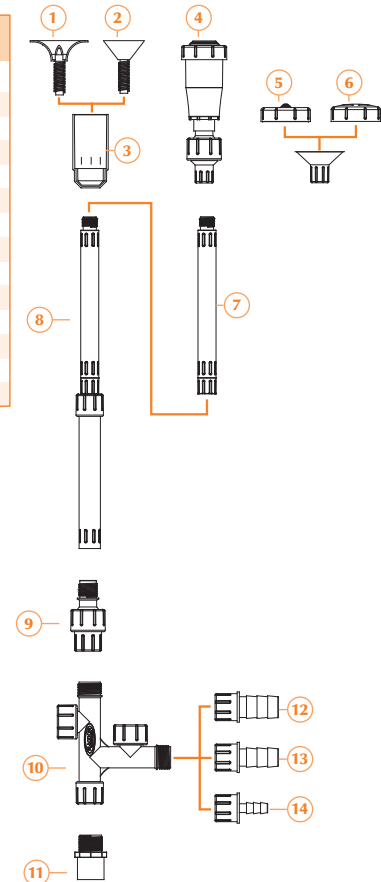

## GETTING TO KNOW YOUR AQUAGARDEN PUMP

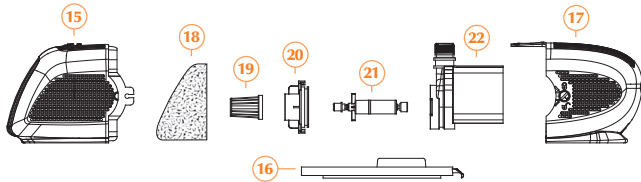

For spares for your Aquagarden Filter select compatible Blagdon spare part numbers

No.	Part Description	Blagdon Codes PUMP 3750	Blagdon Codes PUMP 4750
15	Pre-filter Cage (Front)	1050302	1050302
16	Pre-filter Cage (Base)		
17	Pre-filter Cage (Back)		
18	Optional Pre-filter Foam	105326	105326
19	Optional Pre-filter Cage	N/A	N/A
20	Impellor Cover	N/A	N/A
21	Impellor Complete	1050333	1050340
22	Motor	N/A	N/A

## GETTING TO KNOW YOUR AQUAGARDEN PUMP

### Pump performance/flow rate in litres/hour

HEAD (M)	SMALL POND 3750	MEDIUM POND 4750
2.75		
2.50		
2.25		282
2.00		1012
1.75	485	1613
1.50	890	2138
1.25	1375	2588
1.00	1750	3000
0.75	2000	3375
0.50	2625	3713
0.25	3200	4012
0.00	3712	4750

Flow is given as optimum rate

### Technical Specification and Performance

AQUAGARDEN MODEL	SMALL POND 3750	MEDIUM POND 4750
Cable Fitted	10m	10m
Voltage	230V	230V
Hertz	50Hz	50Hz
Watts	47W	75W
Safety Rating	IP68 C€	IP68 C€
Maximum Flow	3712ltr/hr	4750ltr/hr
	816 gal/hr	1046 gal/hr
Maximum Lift	2m	2.4m
	6'6"	7'8"

## INSTALLATION

### Electrical installation



The power supply must meet the specifications on the product.

The pump is intended to be used with either a weather-proof cable connector or permanently connected to the fixed wiring in the main system other than by means of a plug and socket.

The cores in the supply cable are coloured in accordance with the following code: **Brown = Live, Blue = Neutral, Green/Yellow = Earth.**

The electric cable is permanently connected and sealed in the motor body. If the supply cable is damaged the pump must not be used.

Do not use the supply cable to lift the pump as this may cause damage.

**IMPORTANT:** Please note all electrical work on garden lighting and power installations must comply with part P of the building regulations. Failure to comply is a criminal offence. If the installation of this product is not carried out by a competent electrician who is registered under the Part P self-certification scheme then you must notify the local building control department before work begins. For further information and guidance on this matter and other electrical installations in your home that might be covered by the relevant legislation, contact your local authorities building control department.



#### WARNING - THIS PUMP MUST BE EARTHED

A Residual Current Device (RCD), also known as the Residual Current Circuit Breaker (RCCB), with a tripping current not exceeding 30mA must be installed in the supply circuit.

A means of disconnection from the supply having a contact separation of at least 3mm in all poles must be incorporated in the fixed wiring.

## INSTALLATION

For permanent installations to the mains supply, it is necessary to conform to the regulations of the local electricity authority and this would include the use of a metal or plastic conduit to protect the cable.

Attention has been drawn to the fact that special rules may exist concerning the installation of your pond pump (i.e. local building regulations).

These pumps must not be used in swimming pools, or areas where people are in contact with the water.

Always disconnect the mains electricity supply whilst the equipment is being installed, repaired, maintained or handled. Consult a qualified electrician if in any doubt about wiring this product to the main supply.



**Warning** - The Aquagarden Pump is provided with a thermal cut out that temporarily switches off the pump in case of overheating and the pump may automatically restart.

### Locating your Aquagarden Pump

The Aquagarden pump should be located on a firm and level base in the pond/water feature in a depth of at least 10cm, but no more than 2.2m. It is advisable to keep the pump off the bottom of the pond to avoid silt entering the pump causing excessive wear and increasing pre-filter cleaning.



**Never run the pump out of water as this may cause irreparable damage.**

### Fountain

Make sure there is ample cable from mains supply. Place pump in desired location. Adjust telescopic riser pipe so fountain head is above surface of the pond. Fountain height can now be adjusted, see "Adjusting dual control T-piece" diagram. The fountain ball joint can be used to adjust for uneven pond floors ensuring the fountain display is kept vertical and within the pond. See "Getting to know your Aquagarden pump" fittings for parts and descriptions.

**Tip:** Ensure that any fountain, waterfall, filter or feature fitted does not empty water out of pond/water feature. In windy conditions it may be necessary to shut off or reduce the height of your fountain display to prevent water loss. Also see the explanatory diagram on the top face of your Aquagarden pump carton.

## INSTALLATION

### ADJUSTING DUAL CONTROL T PIECE AND TELESCOPIC RISER PIPE

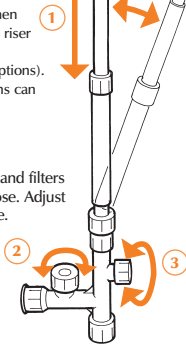
- Adjust height by unlocking collar then pushing or pulling 30cm telescopic riser pipe (see "Getting to know your Aquagarden pump" for parts descriptions). Optional additional 20cm extensions can be added to increase the height.
  - OUTLET FLOW CONTROL VALVE**  
Supply water features, waterfalls and filters by adding 1" 3/4" 1/2" fittings and hose. Adjust flow by turning flow control valve.
  - FOUNTAIN FLOW CONTROL VALVE**  
Adjust fountain jet flow by turning flow control valve.
  - FOUNTAIN BALL JOINT**  
Adjust the collar of the ball joint to enable the extensions to be moved compensating for a uneven pond floor.
- 

### BELL AND TULIP FOUNTAIN

Adjust Bell or Tulip by moving head higher for small bell and lower for a wider bell shape.



## Water Feature / Filter / Waterfall

Install as for Fountain. Depending on water feature to be supplied, your Aquagarden pump can be used with the dual control T-piece 1" 1/4" 1/2" hose fitting (see "Adjusting dual control T-piece" diagram). Hose clips should be used to secure hose.

**Tip:** The larger 1" hose fitting will give maximum pump flow performance.

- Ensure pipe work is not blocked, leaking or is laid so that it gets crushed or kinked.
- Keep the height that water is to be pumped from the water surface (called Head) to a minimum. The higher the head the lower the flow rate and the more wear on the pump.
- Use the largest diameter, smoothest bore pond hose over the shortest distance and keep hose fittings to a minimum. This removes frictional loss of flow and so increases pump flow rates.

Also see the explanatory diagram on the top face of your Aquagarden pump carton.

## MAINTENANCE & CLEANING



**Warning** - Failure to carry out routine maintenance leaving the pump under reduced or no flow conditions for long periods (i.e. blocked optional Daisy fountain pre-filter) will result in a shorter pump life and will invalidate the guarantee.

**Aquagarden Pumps** are centrifugal pumps with a magnetic impeller movement driven by a watertight synchronous motor. They require minimum cleaning, only periodic cleaning of the pre-filter and impeller is necessary.

### Routine Maintenance

Carry out routine maintenance when pump flow is visibly reduced.

- Switch off electricity.
- Remove pump from pond (do not use the cable to lift the pump).
- Remove the front of the pre-filter cage by depressing the button and pulling apart. Wash the cage thoroughly in fresh water. A blocked pre-filter (only used with Daisy Jet fountain) will reduce pump flow. Follow steps 1 and 2 below.

#### STEP 1: ROUTINE

Firmly pull pre-filter cage from pump motor.

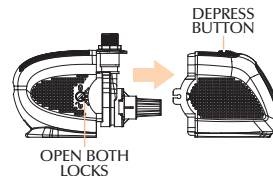

#### STEP 2: ROUTINE

Remove pre-filter foam (if fitted), and wash thoroughly in fresh water. The pre-filter is for use with Daisy Jets only. A blocked foam will reduce the pump flow rate.

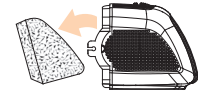

## MAINTENANCE & CLEANING

### Monthly Maintenance

Following as for Routine Maintenance (steps 1 and 2) and then steps 3 and 4.

#### STEP 3: MONTHLY

Remove impeller cover by turning anti-clockwise to release lock.

Then pull firmly away from pump motor and cage.

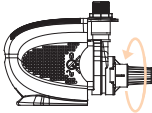

#### STEP 4: MONTHLY

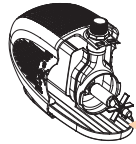

Remove impeller from pump motor. Wash parts with fresh water carefully.

### Annual Maintenance

Dismantle pump and examine all parts for wear or damage, replacing any parts that show obvious wear and/or damage. (See getting to know your pump for parts/description and replacement parts codes.) Particular care should be taken to examine the cable entry point and the cable; if there is any sign of damage the pump should be discarded.

### Winter Storage

The pump can be run in the pond during the winter but care should be taken to ensure that it is fully immersed and cannot freeze solid. If the pump is not used during the winter, follow annual maintenance procedure and store frost-free in the house or garage until spring.

## TROUBLESHOOTING

### Problem

#### Low flow from pump

1. Follow routine cleaning procedure if no improvement.
2. Follow monthly cleaning procedure.
3. Ensure pipe work is not blocked, leaking or is laid so that it gets crushed or kinked.
4. Keep the height that water is to be pumped from the water surface (called Head) to a minimum. The higher the head the lower the flow rate and the more wear on the pump.
5. Use the largest diameter, smoothest bore pond hose over the shortest distance and keep hose fittings to a minimum. This removes frictional loss of flow and so increases pump flow rates.

#### Poor Fountain performance

- Reduced height.
- Jets blocked.

Clean flow adjuster and fountain head. Wash under a tap or hose. Pond Pump Cleaner should be used to remove lime scale build-up/waste (see diagram) for improved results.

Use foam insert with Daisy Jets for lower maintenance.

**DAISY**  
To clean, remove head and rinse.

Use optional foam pre-filter with Daisy Jet heads.



#### No flow from pump

1. Check power supply is on.
2. Check fuse and wiring (SEE ELECTRICAL INSTALLATION).
3. Follow low flow procedure as above.

If none of the above works contact Interpet (Blagdon) Consumer Advice Department (See Faults problem procedure Page 12).

## IMPORTANT

### FAULTS - PROBLEMS PROCEDURE

Before returning your Aquagarden pump to your dealer or contacting our Consumer Advice Department, please carry out the following steps. This will solve most problems quickly and easily.

1. Ensure electrical procedure has been followed fully. Check fuse and any cable connectors/switch boxes.  
**NOTE:** If the pump has overheated the thermal overload will temporarily switch off the pump.
2. (a) Follow routine maintenance and check pump. (b) Follow monthly maintenance and check pump. (c) Follow troubleshooting guide. (d) Follow annual maintenance guide.
3. Return pump to point of purchase for inspection and advice (You may need proof of purchase).

### Consumer Advice contact details

#### Interpet (Blagdon) Consumer Advice Department

Vincent Lane, Dorking, Surrey RH4 3YX

**Telephone:** 0845 226 7437

(Monday to Friday 10am to 1pm except Bank Holidays - Times may vary)

**Fax:** 01306 876712

**E-mail:** [customer-care@interpet.co.uk](mailto:customer-care@interpet.co.uk)

[www.aquagarden-range.co.uk](http://www.aquagarden-range.co.uk)

## GUARANTEE

This product is guaranteed against defects in material and workmanship for 3 years from the date of purchase, under normal usage. **The guarantee DOES NOT APPLY in case of improper use**, negligence, lack of maintenance or accidental damage either to the pump or to the impeller or impeller shaft. If the pump fails due to a manufacturing fault within this period it will be either repaired or replaced free of charge. Liability is limited to replacement of the faulty product only, no other costs will be reimbursed.

This guarantee is not transferable and does not affect your statutory rights. This guarantee does not confer any rights other than those expressly set out above. Excludes the sponge pre-filter, which should be replaced every six months and the impeller, which may require replacing annually. If any parts need replacing, spares are available from your retailer.

## Environment friendly disposal



You can help protect the environment.

Please remember to respect the local regulations: hand in the non-working electrical equipments to an appropriate waste disposal centre.